



Chesterfield House, South Audley Street

Mayfair

OLIVER BERNARD

LONDON

Chesterfield House, South Audley Street, Mayfair, London, W1K

£3000 per week



The Property

CHESTERFIELD HOUSE, SOUTH AUDLEY STREET, MAYFAIR, LONDON, W1K

This Large spacious three bedroom apartment with balcony, set on the seventh floor with west facing views towards Hyde Park. Widely considered one of Mayfair's premier apartment blocks, Chesterfield House is a smart period apartment building located at the southern end of South Audley Street.

This spacious apartment spans over 1800 sq. ft and has well planned and balanced proportions. Of particular note is the elegant reception room with two sets of French doors opening onto the west facing balcony.

All principal rooms radiate off the main hallway, with three bedrooms (two en suite), a kitchen/ breakfast room, third bedroom and guest shower room. The layout is well considered and offers flexible family sized accommodation over one level. The apartment's unique feature is the location within the building - on the favoured west side and the high floor providing elevated views towards the park. Rarely do seventh floor apartments come to market.

THE DETAILS

- Long Let
- Minimum term 6 months
 - 3 Total Bedrooms
 - 1 Reception Room
 - 3 Bathrooms
 - Flat/Apartment
 - Upper Floor
 - Balcony
- Resident Parking
- 1816 Approx Sq Ft
- 24 Hr Concierge
- Air conditioned



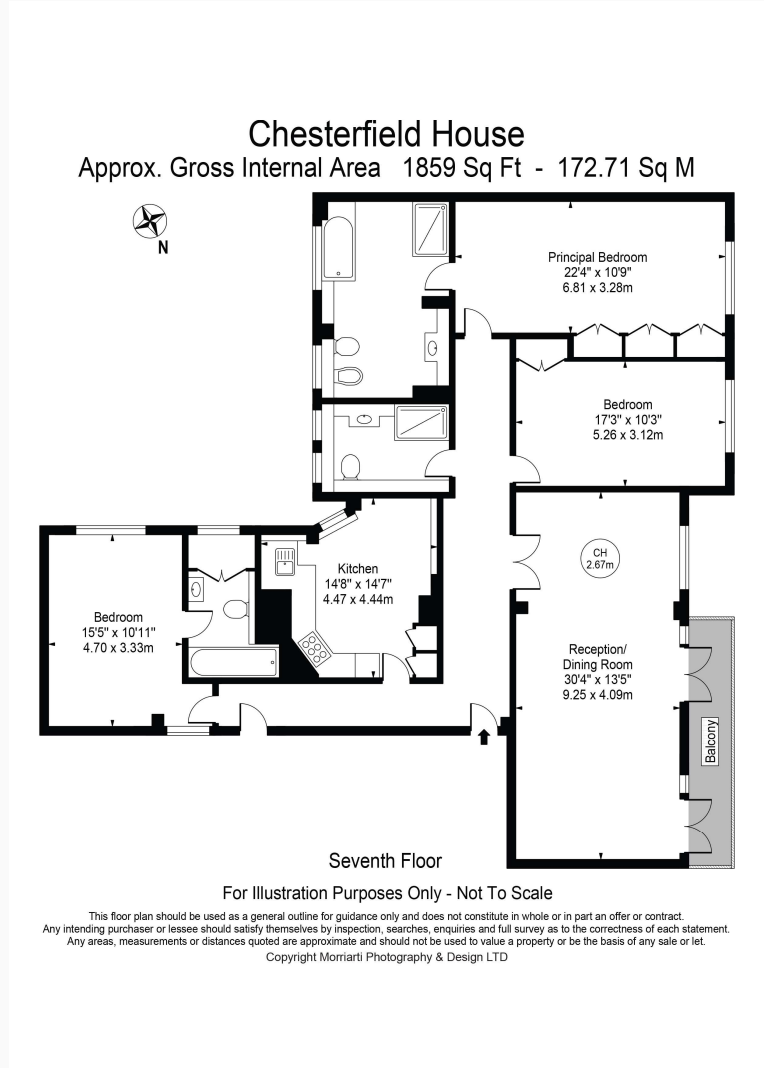

i

Not to scale, for guidance only and must not be relied upon as a statement of fact. All measurements and areas are approximate only and have been prepared in accordance with the current edition of the RICS Code of Measuring Practice.

Important Information

Our property particulars do not represent an offer or contract, or part of one. The information given is without responsibility on the part of the agents, seller(s) or lessor(s) and you should not rely on the information as being factually accurate about the property, its condition or its value. Neither OB Private nor any-one in its employment or acting on its behalf has authority to make any representation or warranty in relation to this property. We have not carried out a detailed survey, nor tested the services, appliances or fittings at the property. The images shown may only represent part of the property and are as they appeared at the time of being photographed. The areas, measurements and distances are approximate only. Any reference to alterations or use does not mean that any necessary planning permission, building regulation or other consent has been obtained. The VAT position relating to the property may change without notice.



Energy Efficiency Rating		
	Current	Potential
Very energy efficient - lower running costs		
(92+) A		
(81-91) B		
(69-80) C		
(55-68) D		
(39-54) E		
(21-38) F		
(1-20) G		
Not energy efficient - higher running costs		
England, Scotland & Wales	EU Directive 2002/91/EC	



Contact

Christian Marks

OLIVER BERNARD PRIVATE MAYFAIR

3RD FLOOR FRONT
33 BRUTON STREET
LONDON
W1J 6QU

INFO@OBPRIVATE.CO.UK
02071180747

